

THIS INFORMATION IS CONFIDENTIAL AND PROPRIETARY TO CW INDUSTRIES INCORPORATED AND ITS AFFILIATES. IT MAY NOT BE DISCLOSED TO ANYONE, OTHER THAN CW INDUSTRIES PERSONNEL, WITHOUT WRITTEN AUTHORIZATION FROM CW INDUSTRIES INCORPORATED, SOUTHAMPTON, PENNSYLVANIA USA.

DIMENSIONS IN INCHES (MILLIMETERS)  
DO NOT SCALE DRAWING .....

REVISIONS	0	NEW	1/31/17	1/31/17	2017
	1				

Toppers shown can change your panel appearance and product styling. Be certain to allow enough clearance between top of switch and bottom of Topper by selecting correct switch button height.

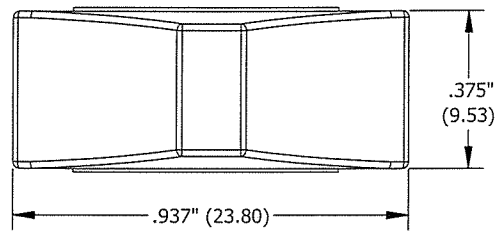

**G-02-56**

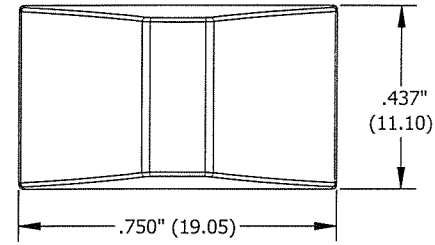

**G-02-331**

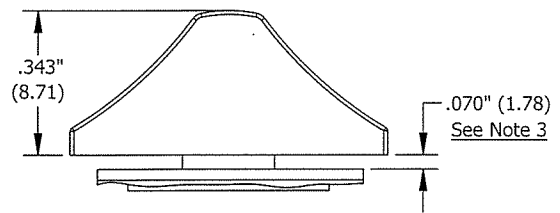
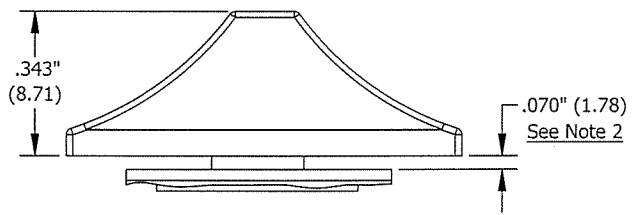

**NOTES:**

- 1) Dimension .070" (1.78) is standard with .328" (8.33) button height. This dimension will vary with optional button heights. Consult Factory.
- 2) G-02-56 Topper standard color is Black, and are available in a variety of colors. Hot Stamping is also available. Consult Factory.
- 3) G-02-331 Topper standard color is White, and are available in a variety of colors. Consult Factory.

<b>CW INDUSTRIES</b> Southampton, Pa. 18966	Title: <b>MINIATURE SLIDE SWITCH ACTUATOR TOPPER OPTIONS</b>	
	<b>TOLERANCES UNLESS OTHERWISE SPECIFIED</b> 2 Place Decimal ± .010      METRIC 3 Place Decimal ± .005      1 Place Dec. ± .25mm Angles ..... ± 1'      2 Place Dec. ± .13mm	
Made for: CW IND.	Division: SWITCH	
Drawn by: DGW 1/31/17	Dwg. No.	
Checked by: G. Gold 2-6-7		
Approved: <i>[Signature]</i> 2/2/17		