

THIS INFORMATION IS CONFIDENTIAL AND PROPRIETARY TO CW INDUSTRIES INCORPORATED AND ITS AFFILIATES. IT MAY NOT BE DISCLOSED TO ANYONE, OTHER THAN CW INDUSTRIES PERSONNEL, WITHOUT WRITTEN AUTHORIZATION FROM CW INDUSTRIES INCORPORATED, SOUTHAMPTON, PENNSYLVANIA USA.

Rating	16(4)A 250V ac 		
Contact Resistance	50m ohm Max		
Insulation Resistance	DC 500V 100M ohm Min		
Dielectric Strength	AC 1500V 1minute		
Switch Function	2P SPST ON-OFF		
Operation Temperature	0°C~85°C		

Material:

- Frame: Nylon 66
- Cover: PA 66 + 30% GF
- Lever: Plastic
- Terminal: Copper Alloy
- Contact: Copper Alloy
- Water proof and Dust proof to fit IP56

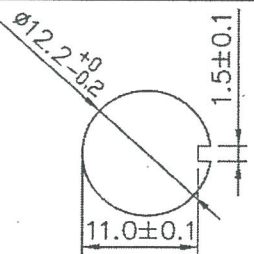
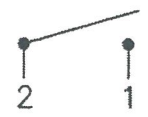
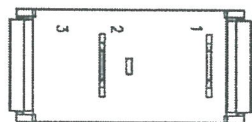
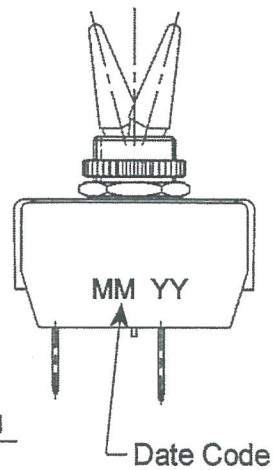
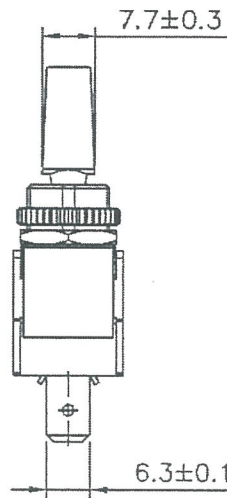
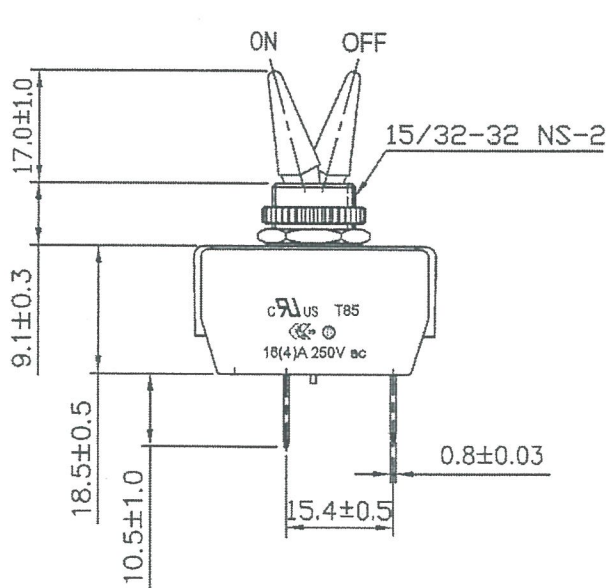
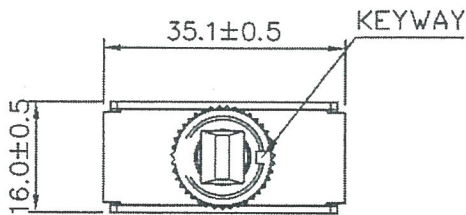

ORDER CHART	
Series	Function
GTS447	A 3 01 H R
-Knurl Nut	
Paddle Type	Terminal Type
	Hex Nut

RoHS Compliant

R13-447A-3-01-HR

2 Updated Order Chart, SCI part number & CWI logo APhilip 06/06/23

1 16(4)A 250vac replaced 20A 277vac 1HP 277vac ratings. Added notes & date code. 8-22-12.

CW INDUSTRIES
Southampton, Pa. 18966
Tel 215.355.7080/www.cwind.com

Date Drawn: 8/24/2010

Rev. 2

Unit: mm

Checked By: *G. GULD*

Title: TOGGLE SWITCH

CW P/N: GTS447A301HR

MASTER