

THIS INFORMATION IS CONFIDENTIAL AND PROPRIETARY TO CW INDUSTRIES INCORPORATED AND ITS AFFILIATES. IT MAY NOT BE DISCLOSED TO ANYONE, OTHER THAN CW INDUSTRIES PERSONNEL, WITHOUT WRITTEN AUTHORIZATION FROM CW INDUSTRIES INCORPORATED, SOUTHAMPTON, PENNSYLVANIA USA.

Rating	16A 125VAC, 10A 277VAC	UL US
	16A 125VAC 3/4HP, 10A 277VAC 3/4HP	
	21A 14VDC, 10A 28VDC	
Contact Resistance	50m ohm Max.	
Insulation Resistance	DC 500V 100M ohm Min.	
Dielectric Strength	AC 1500V 1 minute	
Operation Temperature	-20°C ~ +85°C	

ILLuminated Rocker Options

LED 1 LED 2

Double Pole Version

LED 2

Available in Function A(ON-OFF)

Cut - Out

	X		Y
	X	Y	
0.75~1.25	36.6 +0.1 -0		
1.25~2.0	36.8 +0.1 -0	21.2+0.1	
2.0~3.0	37.0 +0.1 -0		

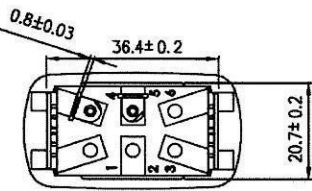
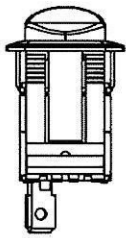
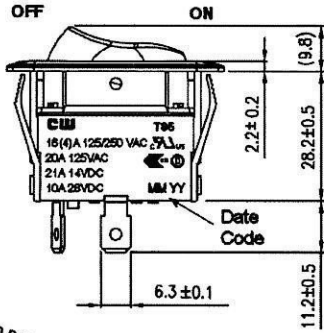
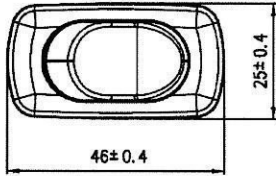

- Features:**
- Frames: Black, Nylon (UL Flame: 94HB).
 - Actuator: Black, Nylon w/GF (UL Flame: 94HB).
 - Terminals: Silver plated brass.
 - NON ILLuminated Switch: Rated IP65.
 - ILLuminated Switch: NO IP Rating.

Actuator/Lens Color List

- A = Amber G = Green
- B = Black R = Red
- U = Blue W = White

Lamp	Voltage
Bulb:B	1=12VDC, 2=24VDC
Neon:N	1=125VAC, 2=250VAC
Led:L	1=12VDC, 2=24VDC, 3=Reg.
Led:L	4=125VAC, 5=250VAC

Order Chart

Actuator Type Terminal Type

Series Actuator Color LED 2 Color Lamp Printing y or n

GRB263

Function Frame Color LED 1 Color Circuit LED Voltage

FUNCTION

A 	E 	I 	P
B 	F 	K 	Q
C 	G 	M 	R
D 	H 	N 	S

*() =momentary

ROCKER	LIGHT CIRCUIT
0	N
1	1
2	2
3	3
7 Laser mark	4
TERMINAL	
0 1	5
0 4	6
0 5	7
0 8	8

CW INDUSTRIES
Southampton, Pa. 18966
Tel 215.355.7080/www.cwind.com

Date Drawn: DW 4/29/21	Rev. 0	Unit: mm	Checked By:
Title: ROCKER SWITCH		CW P/N: GRB263 SERIES	