

DIMENSIONS IN INCHES (MILLIMETERS)
DO NOT SCALE DRAWING

Dwg. No.

GC-536A-0113

SPECIFICATIONS:

MATERIALS:

HOUSING & BASE - Nylon and or Glass Filled
Nylon 6/6 UL 94-V2 minimum

ACTUATOR - Nylon 6/6 UL 94-V2 minimum

MOVING CONTACT - Copper Alloy/Phos. Bronze Silver Plated

STATIONARY CONTACT - BeCu 174 Alloy/.75 in. Silver Plated

TERMINAL - Copper Alloy CDA 260, .100 SnPb 90/10 min.
Over Flash Copper

ELECTRICAL RATING - 1A. 125V.A.C.
3A. 14V.D.C.

MECHANICAL PERFORMANCE - 30,000 Cycles minimum
at Rated Load.

OPERATING FORCE - 9 - 13ozs.
2.5 - 3.5 Newtons,
Spec. as Tested

VOLTAGE DROP - Less than 100mV @ 1A.

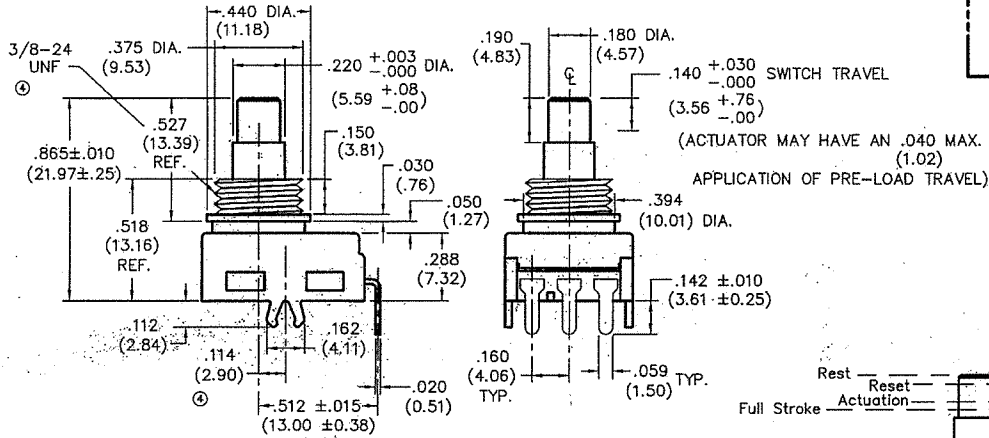
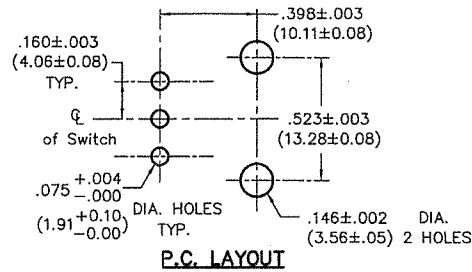
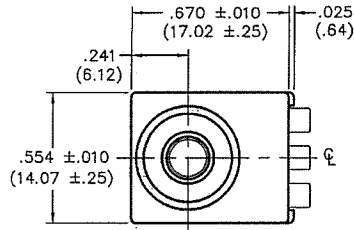
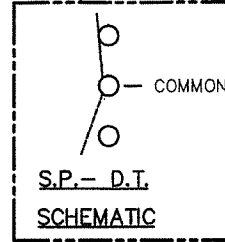

BOTTOM VIEW

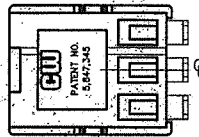

SWITCH TRAVEL SPECIFICATIONS

* Mating Part can Pre-Load Actuator
down to .825 (20.96) Max.

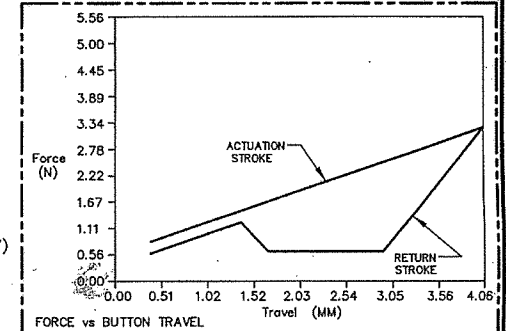
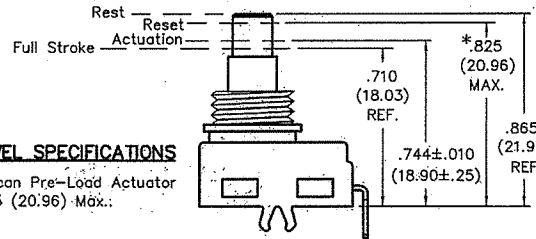

E
D
C
B
A

1 2 3 4 5 6 7 8 9 10

B-FORMAT 2002

REVISIONS

4	REDRAWN, REMOVED .083 AND ADDED .114 AND 3/8 24 UNF TO DRAWING. DOW 6-01-2011
---	-------------------------------------------------------------------------------

6/1/2011

ATTENTION

THIS DRAWING AND ITS ATTACHMENTS, IF ANY, ARE PROPRIETARY TO CW INDUSTRIES AND DESCRIBE DESIGNS THAT ARE CONFIDENTIAL AND MUST NOT BE DISCLOSED UNLESS AUTHORIZED, IN WRITING, BY AN OFFICER OF CW INDUSTRIES.....

CW INDUSTRIES
Southampton, Pa. 18966

TOLERANCES UNLESS OTHERWISE SPECIFIED

2 Place Decimal ±.010	METRIC
3 Place Decimal ±.005	1 Place Dec. ±.25mm
Angles ±1°	2 Place Dec. ±.13mm

Made for: CW IND.
Drawn by: DGW 1-06-2005
Checked by: *CP*
Approval: *C. Peckham 6/1/2011*

Title: SWITCH ASSY.
PUSH ON-PUSH OFF
LIGHT FORCE S.P./D.T.
PCB VERSION W/DAMPER

Division: SWITCH
Dwg. No. GC-536A-0113

MASTER