

THIS INFORMATION IS CONFIDENTIAL AND PROPRIETARY TO CW INDUSTRIES INCORPORATED AND ITS AFFILIATES. IT MAY NOT BE DISCLOSED TO ANYONE, OTHER THAN CW INDUSTRIES PERSONNEL, WITHOUT WRITTEN AUTHORIZATION FROM CW INDUSTRIES INCORPORATED, SOUTHAMPTON, PENNSYLVANIA USA.

Rating	16A 125VAC, 10A 277VAC 16A 125VAC 3/4HP, 10A 277VAC 3/4HP 21A 14VDC, 10A 28VDC
Contact Resistance	50m ohm Max.
Insulation Resistance	DC 500V 100M ohm Min.
Dielectric Strength	AC 1500V 1 minute
Operation Temperature	-20°C ~ +85°C

**ILLuminated Rocker Options**

LED 1 LED 2

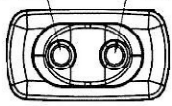

**Double Pole Version**

LED 2

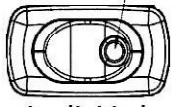

Available in Function A(ON-OFF)

**Cut - Out**

	X		Y
	X	Y	
0.75~1.25	36.6 +0.1 -0		
1.25~2.0	36.8 +0.1 -0	21.2+0.1	
2.0~3.0	37.0 +0.1 -0		

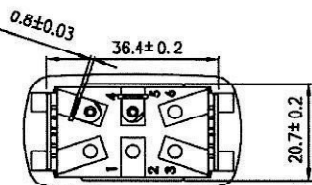
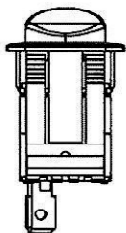
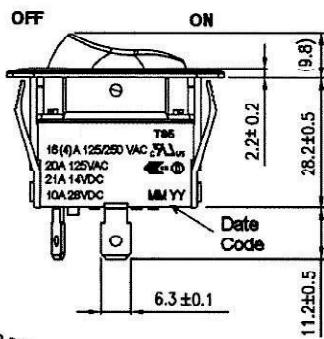
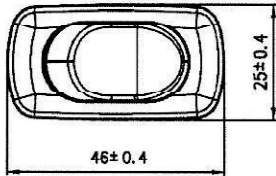

**Features:**

- Frames: Black, Nylon (UL Flame: 94HB).
- Actuator: Black, Nylon w/GF (UL Flame: 94HB).
- Terminals: Silver plated brass.
- NON ILLuminated Switch: Rated IP56.
- ILLuminated Switch: NO IP Rating.

**Actuator/Lens Color List**

- A = Amber G = Green
- B = Black R = Red
- U = Blue W = White

Lamp	Voltage
Bulb: B	1=12VDC, 2=24VDC
Neon: N	1=125VAC, 2=250VAC
Led: L	1=12VDC, 2=24VDC, 3=Reg.
Led: L	4=125VAC, 5=250VAC

**Order Chart**

Actuator Type Terminal Type

Series Actuator Color LED 2 Color Lamp Printing y or n

GRB263

Function Frame Color LED 1 Color Circuit LED Voltage

**FUNCTION**

<b>A</b> ON OFF 2P SPST	<b>E</b> ON OFF ON 6P DPDT	<b>I</b> ON (ON) 3P SPDT	<b>P</b> ON (ON) 6P DPDT
<b>B</b> ON ON 6P DPDT	<b>F</b> ON OFF 4P DPST	<b>K</b> ON OFF (ON) 6P DPDT	<b>Q</b> ON (OFF) 4P DPST
<b>C</b> ON ON 3P SPDT	<b>G</b> ON OFF (ON) 3P SPDT	<b>M</b> ON OFF (ON) 6P DPDT	<b>R</b> ON (OFF) 2P SPST
<b>D</b> ON OFF ON 3P SPDT	<b>H</b> ON OFF (ON) 3P SPDT	<b>N</b> ON OFF 2P SPST	<b>S</b> ON OFF 4P DPST

(\*) = momentary

**ROCKER**

0 1 2 7

**LIGHT CIRCUIT**

N 1 2 3 4 5 7 8

**TERMINAL**

0 1 □ .250" SQ

0 4 □ SAE SQ

0 5 □ SO

0 8 □ SC 6-32UNC

1 Changed IP65 to IP56. DW 2/13/25

**CW INDUSTRIES**  
Southampton, Pa. 18966  
Tel 215.355.7080/www.cwind.com

Date Drawn: DW 2/13/25

Rev. 1

Unit: mm

Checked By: *G. GOLD*

Title: **ROCKER SWITCH**

CW P/N: **GRB263 SERIES**